

## Child car seat instructions

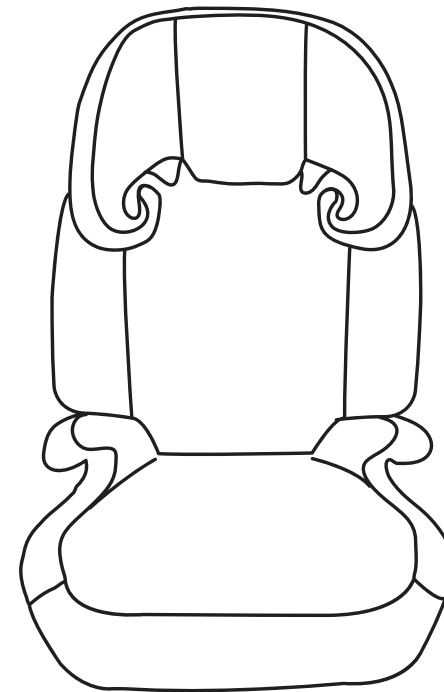

**Please read the instruction manual  
before using the child car seat**

Group II,III  
Group II: 15kg-25kg (approx.3 years-7 years)  
Group III: 22kg-36kg (approx.6 years-12 years)  
Universal ECE R44/04

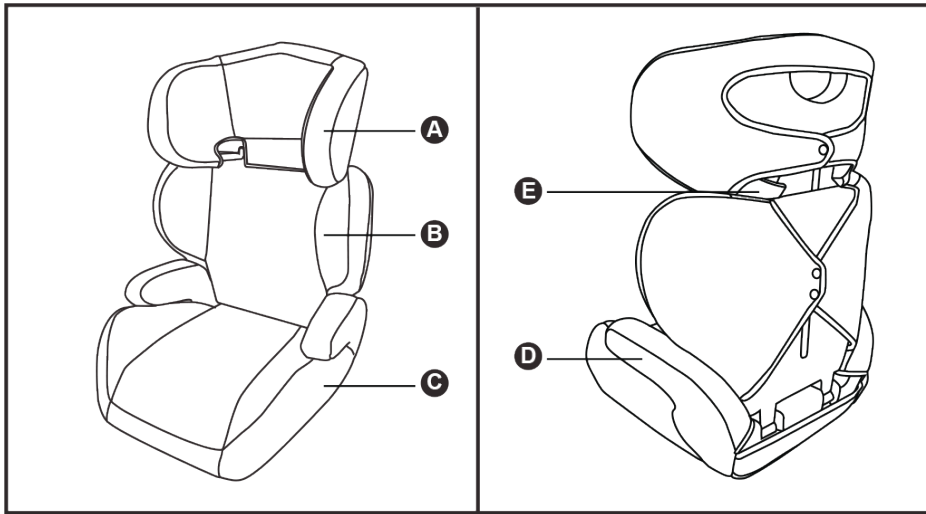

1

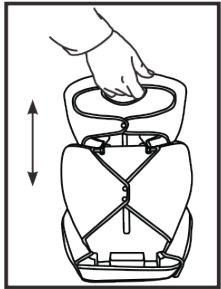

2

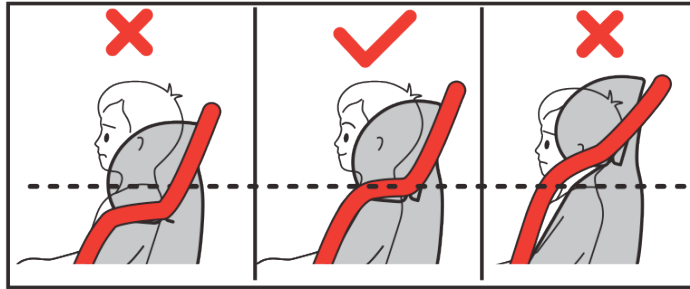

3

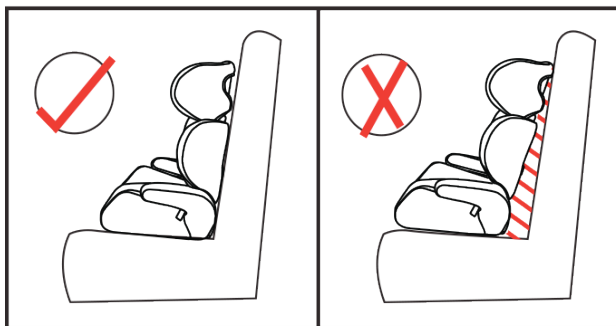

4



5

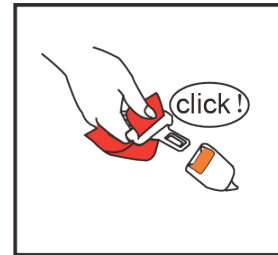

6



7

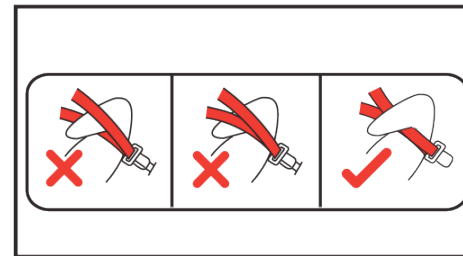

8

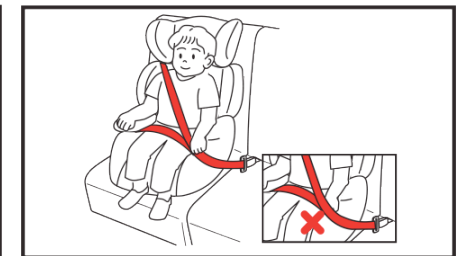

9

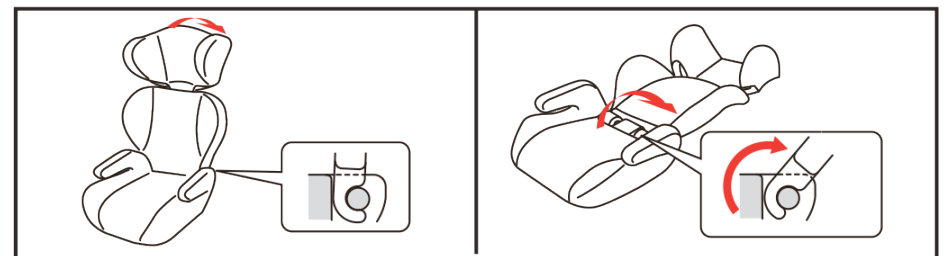

10

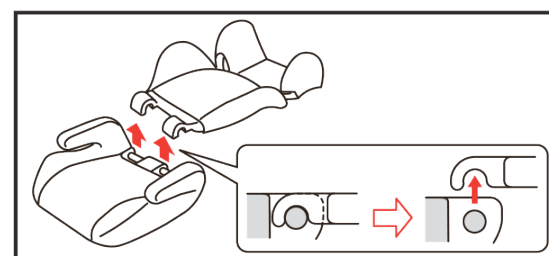

11

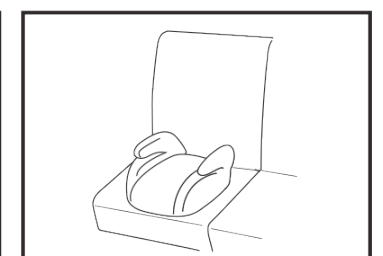

12

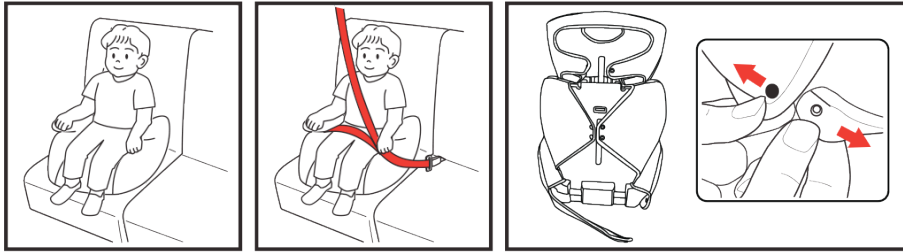

13

14

15

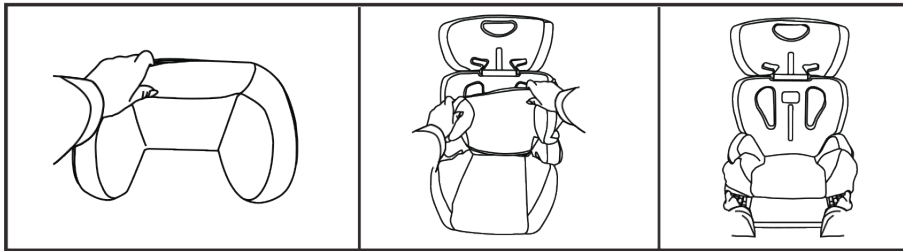

16

## Table of Contents:

1. Introduction .....	2
2. Suitability .....	2
3. Safety advice .....	3
4. Vehicle application .....	4
5. Components overview .....	4
6. Adjusting the belt system to the size of your child.....	4
7. Installing your child car seat and securing your child for group II (15-25kg).....	5
8. Installing your child car seat and securing your child for group II and III (15-36kg).....	5
9. Removing the cover .....	6
10. Cleaning the cover .....	6

## 1. Introduction

Thank you for choosing our child car seat. In order to gain the most comprehensive protection of your child, please read carefully and follow the instruction for correct installation and retain for future use. If you have any questions, please contact us.

This is a “Universal” child car seat. It conforms to ECE R44/04 for general use in vehicles. It will fit most, but not all vehicle seats.

## 2. Suitability

The child car seat is suitable for children from 15kg to 36kg with only forward facing. The child car seat can be used with or without the backrest. It depends on the weight and age of the child.

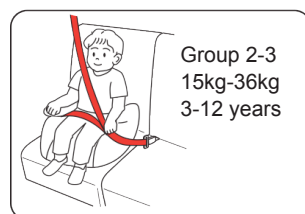
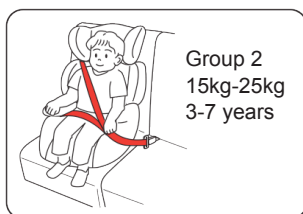

The child car seat can only be used in vehicle that is fitted with 3-point safety belt approved to ECE-16 or the equivalent standard. Never use a 2 point safety belt. The car seat must only be installed by using a lap and diagonal seat belt.

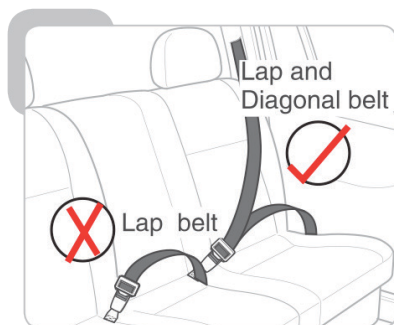

Correct Fitting/ Suitable



Incorrect Fitting/ Not Suitable

## 3. Safety advice

- (1). Please read the entire instruction manual thoroughly before using the child car seat. Improper installation can endanger the life of your child.
- (2). Under no circumstances should the seat be installed on a passenger seat equipped with an airbag. This can be very dangerous.
- (3). It is most important that the seat belt is correctly routed.
- (4). Never make unauthorized alterations or additions to the product.
- (5). Never use the child car seat if it has been in an accident, or if it has become badly worn.
- (6). Do not leave your children in the seat unattended at any time.
- (7). Child car seat parts may become hot in direct sunlight. Cover with a sheet to prevent this.
- (8). Ensure that all other passengers, luggage and loose objects are properly secured.
- (9). Never use the child car seat without cover. Only covers approved by manufacturer can be used.
- (10). The child car seat must be secured when not in use.
- (11). Store this child car seat in a safe place when it is not being used. Avoid placing heavy objects on it.
- (12). Most accidents occur on short trips, so do not be tempted to avoid using the seat simply because you are not travelling very far.
- (13). Make sure to keep plastic bag long distance from your child as it is likely to cause suffocation.
- (14). Do not expose the child car seat to any corrosive substance. Use wet towel to clean the plastic body instead of any solvent when the plastic body is dirty.
- (15). It's very important to put any lap belt low down so that the pelvis is firmly stressed.
- (16). Do not use this product second hand as you never know its history.

#### 4. Vehicle application



Not allowed to install child car seat.



Be careful to install child car seat. Installation is permitted only if there is 3-point belt. The seat may not be installed in the area of effect of an airbag.



Safe to install child car seat.

#### 5. Components overview (fig.1)

A-Headrest  
B-Backrest  
C-Seat base  
D-Armrest  
E-Belt hook

#### 6. Adjusting the headrest to the size of your child

6.1 Hold the headrest with one hand at the top.(fig.2)  
6.2 Pull the headrest up until you feel some resistance, continue to pull until you hear a “Click”. The headrest will now sit in the next height position.  
6.3 To lower the height of the headrest, follow the reverse of 6.1 and 6.2 above.



WARNING

- Make sure the shoulder belt is on the same height as your child shoulder. Otherwise, adjust the headrest to the suitable height.(fig.3)

#### 7. Installing your child car seat and securing your child for Group II (15-25kg)

7.1 Place the child car seat on the passenger seat ensuring it is firmly against the vehicle seat.(fig.4)  
7.2 Sit your child on the child seat with their back against the backrest. (fig.5)  
7.3 Position the lap section of the safety belt under both armrests(D), insert the buckle tongue in the belt buckle until you hear a clear “Click”(fig.6), pull the lap belt tight. Thread the shoulder belt under the armrest and then through the belt hook(E) on the headrest. It is important that the diagonal belt lies comfortably over your child’s shoulder.(fig.7)  
7.4 Make sure that both shoulder belt and lap belt must go under armrests. (fig.8)  
7.5 Make sure your child arms are above both diagonal and lap belt.(fig.9)

#### 8. Installing your child car seat and securing your child for Group II and III (15-36kg)t

8.1 Removing the backrest  
8.1.1 Hold the seat base with one hand and one hand push backrest until backrest is horizontal to seat base.(fig.10)  
8.1.2 Separate the backrest from seat base.(fig.11)  
8.2 Place the child car seat booster cushion on the passenger seat ensuring it is firmly against the vehicle seat.(fig.12)  
8.3 Sit your child on the child seat with their back against the backrest.(fig.13)  
8.4 Position the lap section of the safety belt under both armrests. Insert the buckle tongue in the belt buckle until you hear a clear “Click”(fig.6) and pull the lap belt tight. Thread the shoulder belt under the armrest and on the child’s shoulder. It is important that the diagonal belt lies comfortably over your child’s shoulder.(fig.14)  
8.5 Make sure that both shoulder belt and lap belt must go under armrests. (fig.8)  
8.6 Make sure your child arms are above both diagonal and lap belt.

## 9.Removing the cover

9.1 Undo the velcro on back of headrest, backrest and seat base cover.

(fig.15)

9.2 Remove headrest, backrest and seat base cover by holding the edge ensuring the cover material does not rip or tear.(fig.16)

## 10. Cleaning the cover

10.1 Hand wash the cover in cold or warm water.

10.2 Do not dehydrate. Suggest to use towel to absorb water and hang dry.

10.3 Do not use detergent that contains chlorine bleach.

10.4 Do not use washing machine, dehydration machine and dryer.



Hand wash



Do not bleach



Do not iron



Do not  
dehydrate



Rub gently



Hang dry